

IMPORTANT - HOW TO REALIGN THE CLEANING CLOTH

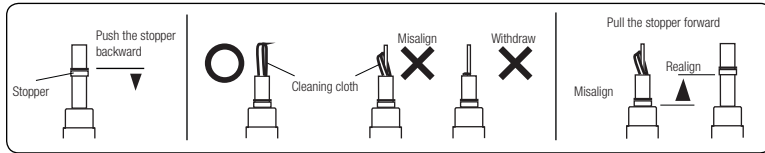

ATTENTION

Please hold the base of the cleaning guide when you tilt the tip upwards. FCCN-250 can be tilted on an angle of 15,30 or 45 degrees. FCCN-125 can be tilted on an angle of 15 or 30 degrees. Do not tilt cleaning guide down: **ONLY TILT UPWARDS**. When you feel the click button does not move smoothly, please check the indicator window (cleaning cloth may be empty).

Jonard Tools assumes no liability whatsoever for actions by a third party, other accidents, intentional or accidental misuse, or use under other abnormal conditions by the user.

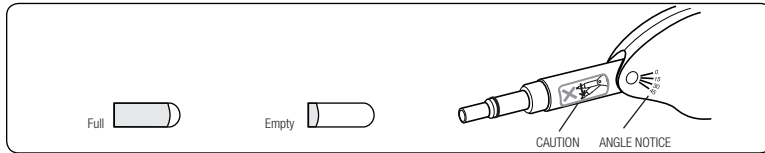

DANGER

- Do not use or leave in places exposed to high temperatures or in places where flammable gases are generated.
- Do not peer through the ferrule end-face and adapters.
- Do not use with live fiber.

WARNING

- Do not subject to strong impact by dropping or throwing this.
- Do not disassemble, make repairs or modify.
- Do not splash with water or other liquids.
- Should this become splashed with liquid, immediately stop cleaning.
- Malfunctions caused by splashing or moisture are outside the scope of the warranty and cannot be repaired.



MADE FOR LIFE®



MADE FOR LIFE®



FCCN-125 & FCCN-250
FERRULE END-FACE CLEANER INSTRUCTION MANUAL

FEATURES

- Adjustable angled head (up to 45°) is perfect for getting into hard-to-reach places
- Flip-open cap makes it easy to insert connectors for cleaning
- Remove cap to clean fiber in bulkhead adapters
- Static-free cloth provides up to 350 swipes per cleaner
- Perfect for cleaning any LC, MU, FC, SC or ST connector

PART DESCRIPTION

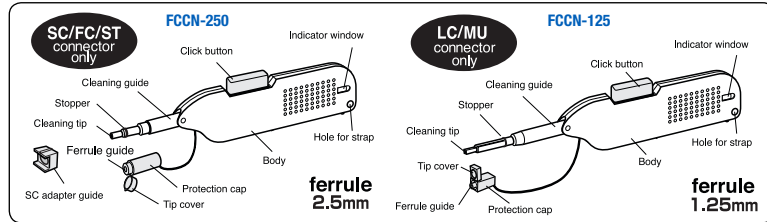

OPERATING INSTRUCTIONS - CLEANING THROUGH ADAPTER

FCCN-250

1. Remove protection cap.

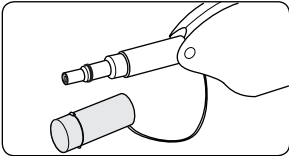

2. Insert cleaning tip into adapter.

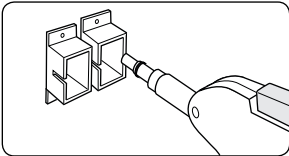

3. Push in until stopper of cleaning guide comes in contact with the adapter. Maintain pressure to realize spring pressure inside adapter.

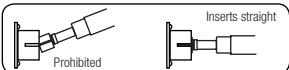
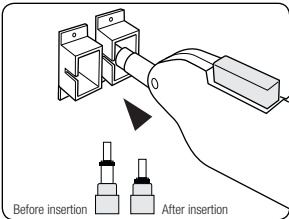

FCCN-125

1. Remove protection cap.

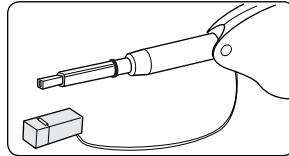

2. Insert cleaning tip into adapter.

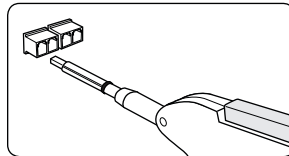

3. Push in until stopper of cleaning guide comes in contact with the adapter. Maintain pressure to realize spring pressure inside adapter.

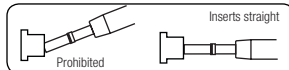
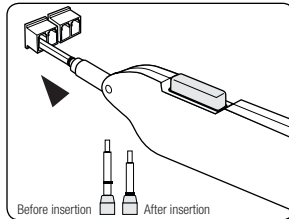

4. Depress and release the click button one time. *Note: for extremely dirty connectors, two click button pushes may be necessary.*

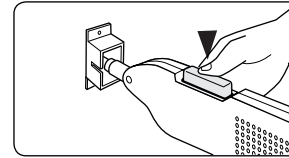

5. Remove ferrule mate from adapter and replace protection cap before storage.

OPERATING INSTRUCTIONS - CLEANING CABLE CONNECTORS

FCCN-250

1. Open tip cover.
2. Insert your ferrule or connector into ferrule guide until ferrule or connector housing contacts the face of the protection cap.

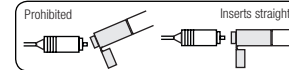
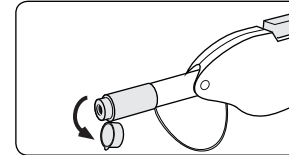

3. Maintain pressure on the ferrule or connector. Depress and release the button one time. *Note: for extremely dirty connectors, two button pushes may be necessary.*

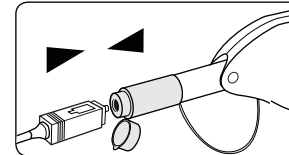

4. Remove your ferrule or connector from the ferrule guide and close the tip cover of the protection cap.

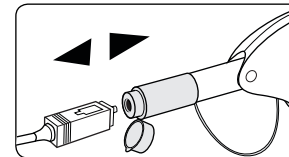

4. Depress and release the click button one time. *Note: for extremely dirty connectors, two click button pushes may be necessary.*

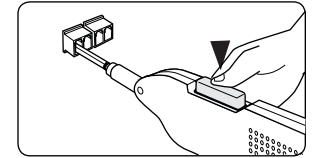

5. Remove ferrule mate from adapter and replace protection cap before storage.

FCCN-125

1. Open tip cover.
2. Insert your ferrule or connector into ferrule guide until ferrule or connector housing contacts the face of the protection cap.

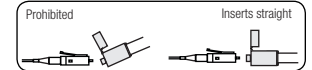
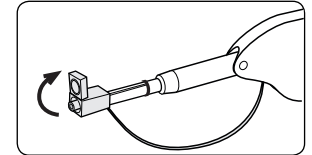

3. Maintain pressure on the ferrule or connector. Depress and release the button one time. *Note: for extremely dirty connectors, two button pushes may be necessary.*

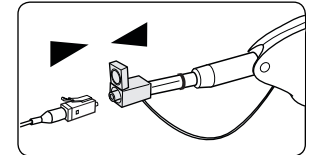

4. Remove your ferrule or connector from the ferrule guide and close the tip cover of the protection cap.

