

Autonics

SHAFT TYPE 5 PHASE STEPPER MOTOR

INSTRUCTION MANUAL

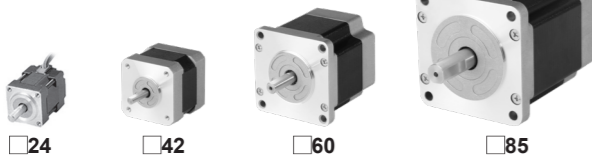

Thank you for choosing our Autonics product. Please read the following safety considerations before use.

Safety Considerations

Please observe all safety considerations for safe and proper product operation to avoid hazards.

Warning symbol represents caution due to special circumstances in which hazards may occur.

Warning Failure to follow these instructions may result in serious injury or death. Caution Failure to follow these instructions may result in personal injury or product damage.

- Fail-safe device must be installed when using the unit with machinery that may cause serious injury or substantial economic loss.
Fix the unit on the metal plate.
Do not connect, repair, or inspect the unit while connected to a power source.
Install the unit after considering counter plan against power failure.
Check 'Connections' before wiring.
Do not disassemble or modify the unit.
Install the motor in the housing or ground it.
Make sure to install covers on motor rotating components.
Do not touch the unit during or after operation for a while.
Turn OFF the power directly when error occurs.

Caution

- Use the unit within the rated specifications.
Use dry cloth to clean the unit, and do not use water or organic solvent.
Do not use the unit in the place where flammable/explosive/corrosive gas, humidity, direct sunlight, radiant heat, vibration, impact, or salinity may be present.
The motor may overheat depending on the environment.

Ordering Information

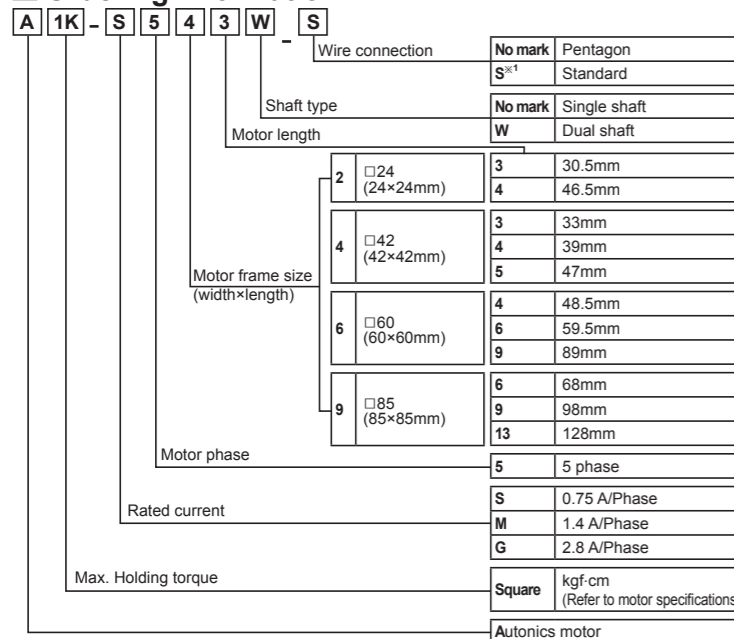

Standard wiring is optional. The above specifications are subject to change and some models may be discontinued without notice.

Specifications

Table with 3 columns: Model, 02K-S523(W), 04K-S525(W). Rows: Max. Holding torque, Rotor moment of inertia, Rated current, Standard step angle, Weight.

Table with 4 columns: Model, A1K-S543(W)-□, A2K-S544(W)-□, A3K-S545(W)-□. Rows: Max. Holding torque, Rotor moment of inertia, Rated current, Standard step angle, Weight.

Table with 8 columns: Model, A4K-S564(W)-□, A4K-M564(W)-□, A4K-G564(W), A8K-S566(W)-□, A8K-M566(W)-□, A8K-G566(W), A16K-M569(W)-□, A16K-G569(W)-□. Rows: Max. Holding torque, Rotor moment of inertia, Rated current, Standard step angle, Weight.

Table with 7 columns: Model, A21K-M596(W)-□, A21K-G596(W)-□, A41K-M599(W)-□, A41K-G599(W)-□, A63K-M5913(W)-□, A63K-G5913(W)-□. Rows: Max. Holding torque, Rotor moment of inertia, Rated current, Standard step angle, Weight.

1: Max. Holding torque is a retaining torque when 5 phase excitation stopped after the rated current is flowed in motor. 2: The weight includes packaging. The weight in parentheses is for unit only.

Common specification

Table with 2 columns: Property (Insulation class, Insulation resistance, Dielectric strength, etc.) and Value (B type (130°C), Over 100MΩ, etc.).

Specifications are for full-step angle, with no-load. Amount of radial shaft displacement when adding a radial load(5N) to the tip of the motor shaft.

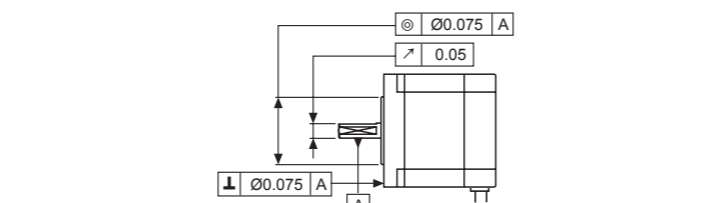

Environment resistance is rated at no freezing or condensation.

Dimensions

The dimensions are for dual shaft models. Single shaft models do not include shafts indicated in the dotted lines.

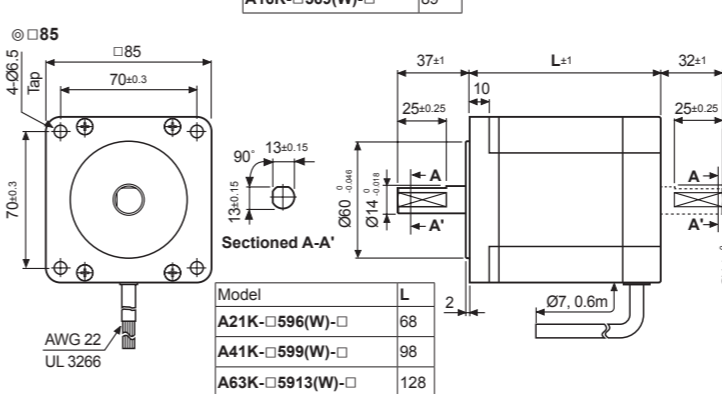
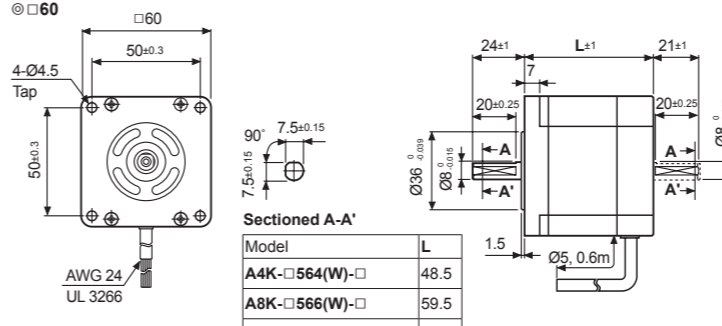
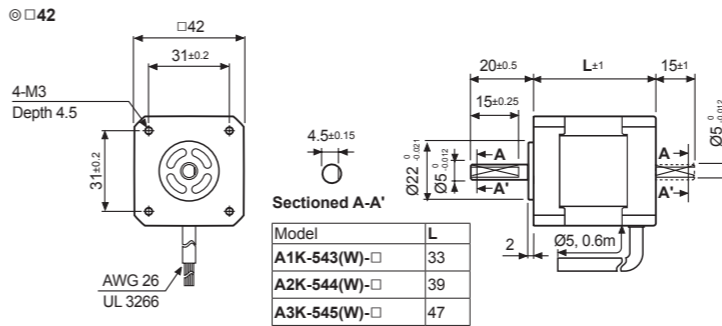
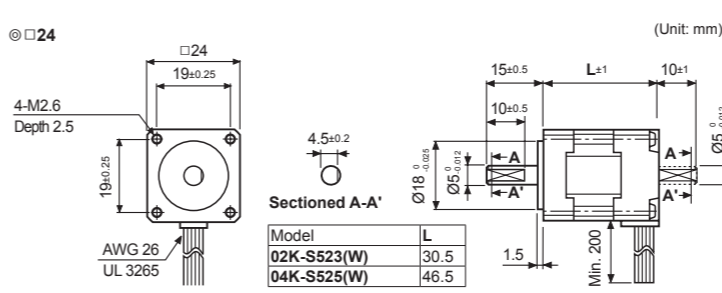

Connection Diagram

Refer to the below for correlations of motor's each phase(coil) and the color of lead wire. Note that Pentagon connection type is a standard model.

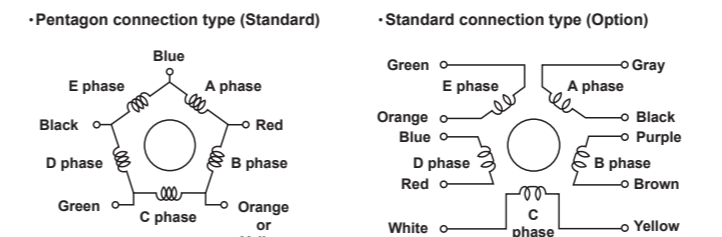

Table mapping lead wire colors to phases for Standard and Pentagon connection types.

Motor Installation

Motor installation direction: The motor can be installed in any direction horizontally, or vertically.

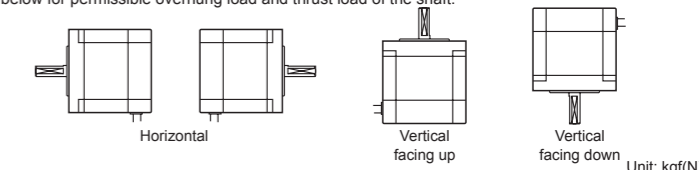

Table of permissible overhung load [kgf(N)] by distance from shaft tip (mm) for motor sizes □24 to □85.

When installing the motor, make sure that excessive force is not applied to the motor cable. Also, the motor cable must not be pulled or inserted too tightly.

Motor installation method: When installing the motor, carefully consider heat radiation and vibration resistance.

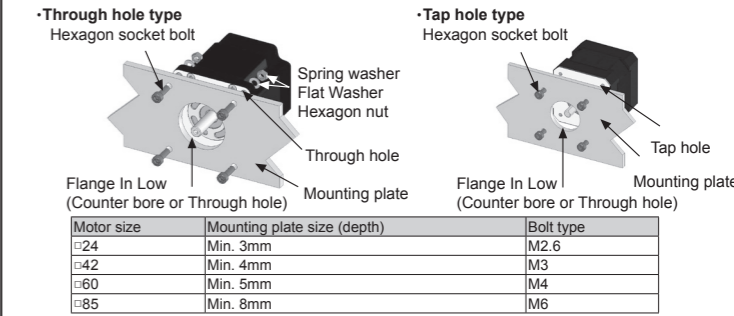

Table of motor size vs. mounting plate size (depth) and bolt type for through hole and tap hole installations.

Load connection: Use a flexible coupling when attaching a load (ball-screw, TM-screw, etc.) directly on the shaft of the motor.

Installation conditions: Please install the motor under the following conditions. Usage outside these conditions may result in product damage.

- Indoor environment (this product is intended for use with machinery).
Ambient temperature: -10°C to 50°C (non-freezing status)
Ambient humidity: 35% to 85%RH (non-condensation)
Environments without explosive, flammable, or corrosive gas
Environments without exposure to direct sunlight
Environments with minimal dust
Environments without direct contact with water or oil
Environments suitable for heat dissipation
Environments without concentrated vibration or excessive shock
Environments with low salinity
Environments with minimal electromagnetic noise from other machinery
Environments without radioactive substances or magnetic fields
Must be installed in a non-vacuum state.

Cautions during Use

- Follow instructions in 'Cautions during Use'. Otherwise, it may cause unexpected accidents.
Using motors at low temperature may cause reducing ball bearing's grease consistency and friction torque is increased.
Start the motor in a steady manner since motor's torque is not to be influenced.

Major Products

- Photoelectric Sensors, Temperature Controllers, Fiber Optic Sensors, Temperature/Humidity Transducers, Door Sensors, SSRs/Power Controllers, Door Side Sensors, Counters, Area Sensors, Timers, Proximity Sensors, Panel Meters, Pressure Sensors, Tachometer/Pulse (Rate) Meters, Rotary Encoders, Display Units, Connectors/Sockets, Sensor Controllers, Switching Mode Power Supplies, Control Switches/Lamps/Buzzers, I/O Terminal Blocks & Cables, Stepper Motors/Drivers/Motion Controllers, Graphic/Logic Panels, Field Network Devices, Laser Marking System (Fiber, CO2, Nd: YAG), Laser Welding/Cutting System.

Autonics Corporation logo and address: 18, Bansong-ro 513 beon-gil, Haeundae-gu, Busan, South Korea, 48002. TEL: 82-51-519-3232. E-mail: sales@autonics.com